

DIGITAL DRY

ASSEMBLY INSTRUCTIONS *for the installer and the user*

Before performing any assembly operation, please read these instructions carefully.

1 - All installation and maintenance operations must be performed by qualified personnel and in compliance with the regulations in force.

2 - The device can be used by children aged no younger than 8 and persons with reduced physical, sensory or mental capabilities, or without experience or necessary expertise, provided they do so under surveillance or after receiving instructions on safe equipment use and on understanding the inherent dangers. Children must not play with the device. Cleaning and maintenance meant to be performed by the user should not be performed by unsupervised children.

Children under the age of 3 should be kept at a distance unless constantly supervised.

Children between the ages of 3 and 8 should only turn the device on/off as long as it was placed or installed in its normal operating position, and that they receive supervision or instruction concerning safe use of the device and understand its dangers.

Children between the ages of 3 and 8 should not plug it in, adjust or clean the device and the device will be maintained by the user.

WARNING - Some parts of this product may get hot and cause burns.

Caution should be exercised when there are children and vulnerable people present.

3 - The manufacturer assumes no responsibility for assembly that does not comply with these instructions or use of non-original material or accessories.

4 - If the power cable is damaged, it must be replaced by the manufacturer or its technical assistance service or a similarly qualified person in order to avoid a hazard.

5 - The heating device should not be placed under an electrical outlet, but rather in such a position that the switches and other control devices cannot be touched by a person when in the bath or shower.

6 - **WARNING:** in order to avoid danger to children, this device should be installed so that the heating grid below is heated to at least 600mm from the floor.

7 - During operation, it is normal that the electronic control side upright is colder.

8 - Do not use the radiator in the presence of gases, explosives or flammable products.

9 - **WARNING:** This device is designed for drying fabrics washed in water

ELECTRICAL CONNECTION

Cables: grey (or blue) = neutral, brown = phase, black = pilot wire

Power supply for single phase 230V ~ 50 Hz.

It must be performed in compliance with the rules in force; before connecting the electrical resistance to the line, check the voltage and power indicated on the rating plate.

For models not equipped with a Specific plug for the French market

The power supply circuit of the radiator must be protected by a differential switch of 30 mA. The opening distance between the contacts must be greater than 3 mm. Moreover, the circuit must be easily accessible.

The pilot wire (black) must be isolated, if not used.

AREA OF INSTALLATION

Thanks to the particular construction, it is possible install the towel warmer in areas 2 and 3.

See example figure 2

Area 2 includes the volume immediately surrounding the bathtub or shower tray extended up to 0.6 m horizontally and up to 2.25 m vertically with the vertical distance measured from the floor. For showers without a tray, there is no area 2 but rather area 1 increased to 1.20 m

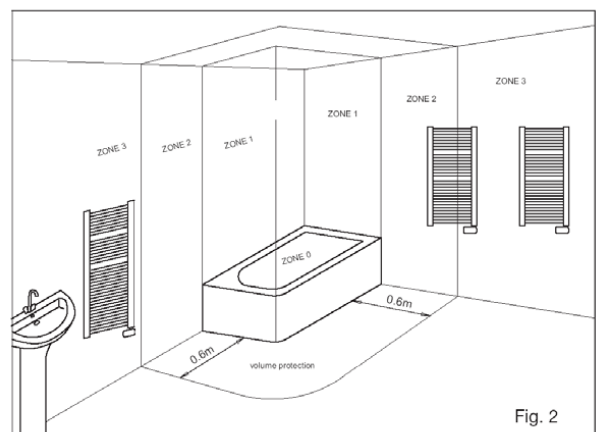

WALL FIXING

1. Use a drill to make four holes on the wall, using a \varnothing 10 mm tip. Next, insert the dowels inside the holes.
2. Place the bases over the holes and secure them with the screws. The bases must be installed with the slot facing upwards for the upper ones and vice versa for the lower ones.
3. Attach the two claws to the radiator following the diagram. The claws must be tightened using the screws supplied as standard. It is necessary to pay attention to their installation direction, so that the upper ones are arranged upwards and the lower ones downwards.
4. Hook the radiator to the bases positioned on the wall, closing them with screws.

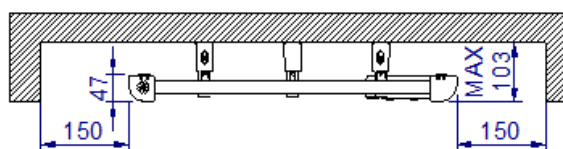
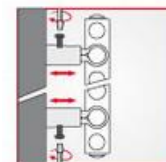
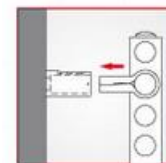
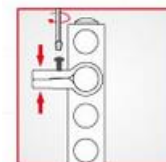
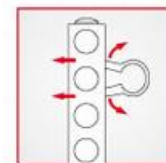
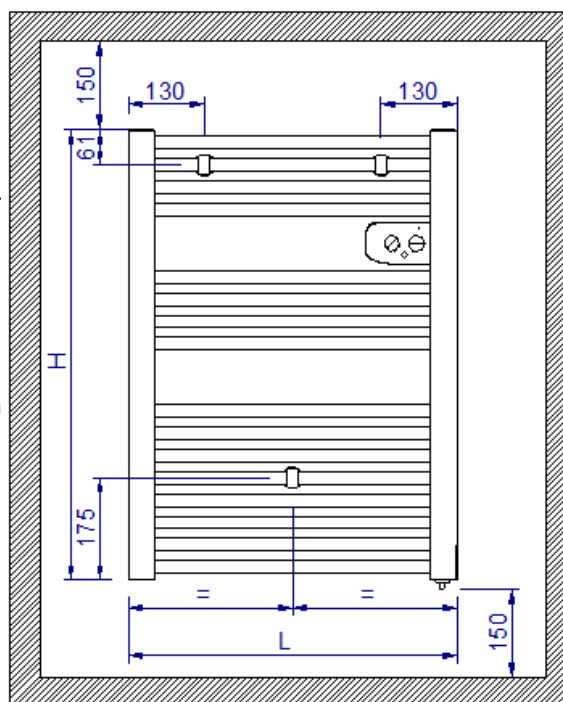

No.	POWER (W)	HEIGHT (mm)	WIDTH (mm)	TUBES No.	WEIGHT (kg)
1	350	792	420	16	3.5
2	400		460		4.2
3	500		560		5.0
4	600	1142	460	24	5.4
5	700		510		6.0
6	750		560		6.6

WARNING FOR PROPER DISPOSAL OF THE PRODUCT IN COMPLIANCE WITH DIRECTIVE 2002/96/EC.

Once its life cycle is over, the product must not be disposed of with household waste but rather transported to a recycling centre run by the pertinent Municipality or delivered to dealers that provide this service. The disposal of the device according to the materials separation principle helps prevent harmful consequences for the environment and health that result from incorrect disposal; it also allows its constituent materials to be recovered, with a considerable saving of energy and resources. In order to remember the requirement that the home devices are subject to separated collection, the crossed-out rubbish bin symbol is applied to the product.



GENERAL WARRANTY CONDITIONS

The warranty is valid for 2 years from the product sale date. The warranty covers the free of charge repair or replacement of defective parts at the plant of the manufacturer. The costs of disassembly, assembly and transportation can under no circumstances be subject to repayment. Under no circumstances can the manufacturer be held responsible for direct or indirect damage to persons or property arising from the malfunction of the device. The warranty does not cover devices installed or used incorrectly or not in compliance with respect to the use for which they were produced. The guarantee does not apply in the event of accidental breakage or negligence.

Warning: it is necessary to intervene on the device only after disconnecting it from the mains grid and these interventions must only be carried out by qualified and authorized staff from the manufacturer.



SET-UP OF THE DEVICE

When you connect the control unit to the power supply, the device is off. To activate it, simply press the on-off button for about 2 seconds (the control will beep) **to turn it off, do the same.**

COMFORT FUNCTION

The "comfort" temperature corresponds to the user's desired ambient temperature.

Press the MODE button to activate the icon.

In this function you can adjust the ambient temperature in a range that varies from 7 to 32°C. This adjustment is made using the plus and minus keys.

If the ambient temperature is lower than that set on the device, it will activate the icon, the  towel warmer is heating. After a few hours, the temperature stabilizes; if necessary, adjust the temperature by increasing or decreasing the set value. If the set temperature is the temperature that you wanted to (if necessary, check the ambient temperature with a thermometer), keep this setting as the definitive one. If you are not satisfied with the temperature, re-adjust it.

BEHAVIOURAL INDICATOR

The behavioural indicator operates based on the ambient temperature.

If a value of less than 19°C is set, the command signal in green, while if they are set in the range between 19 to 24°C the signal is yellow, and above 24°C the signal must be red.

The arrows in the upper left indicate how we are using the device.

PILOT WIRE FUNCTION Specific for the French market

The device is programmable. For this function, it is necessary to have a centralized programmer that will be connected to the pilot wire of the device (black wire). The programmer must provide corresponding commands to the standard GIFAM (=French Inter-professional Grouping of Household Appliance Manufacturers).

The programming control unit must be able to give the following information:

- Comfort: no signal
- ECO = lowering by $3.5^{\circ} \pm 0.5$ K, signal: full wave
- ANTI-FROST at $7^{\circ} \pm 3^{\circ}$ C, negative half wave
- Stop, Signal: positive half wave

All these commands are programmable by the user on the control unit (refer to the manual for settings)

- The commands transmitted from the programmer through the pilot wire are recognized by the thermostat, located in "comfort" mode.
- The device has two additional commands: comfort -1°C (comfort temperature decreased by 1°C) and comfort -2°C (comfort temperature reduced by 2°C). These commands are activated by the utility company and processed by the energy regulator (Power manager). Check with your utility company whether your electrical system is equipped with this type of device.

CHRONO FUNCTION



This allows you to set the temperature for a day.

The Comfort/Night or antifreeze temperature and ranges can be programmed.

The comfort function is the selected temperature (two bars), night corresponds to comfort minus 3.5°C (8 bar) antifreeze to 7 °C (no bars)

Setting the days and time

To enter this function, simply press the MODE key until the 5s icon appears (second beep).

The 'Hours' are flashing: use the [+] and [-] buttons to set it and confirm with the MODE button

The 'Minutes' are flashing: repeat the same procedure and confirm with the MODE button

The arrow indicating the current day flashes: press the [+] and [-] buttons to set the correct current day. Then press the MODE button again to confirm.

Now the display shows the current time.

b) Set the programme

Press the mode button for a time between 2 and 5 seconds (one beep), to access programming mode.

First adjust the comfort temperature setting using the [+] and [-] buttons, quickly pressing the mode to confirm.

(Fast pressure is confirmed, press the mode button for two seconds to exit the command).

Now the time sequence can be set for each day of the week. The flashing arrow indicates the day of the week (1 Monday 7 Sunday).

Start with the first day, select the required sequence using the [+] and [-] buttons to select, for each time, between the 'Comfort temperature' (solid bar) and the 'Night temperature' (half bar at night), antifreeze (no bars). See the figure below for reference.

Press the MODE button to confirm and repeat the same procedure for each day of the week.

The weekly programme is set.

2h FUNCTION (BOOST) 2h

To heat a room faster or to dry towels, it is possible to activate the 2h function.

The function is activated with the MODE button until you get to the function in the **2h symbol**.

The unit will heat at its maximum power for a period of 2 hours, at this stage, it is not possible to adjust the room temperature.

A 35°C cap is included however. When this threshold is exceeded, the "child" protection is automatically triggered.

After the two hours, the command returns to the previous function.

TOWEL WARMER FUNCTION



This function is activated by pressing the MODE button until the icon is selected.

This particular function allows towels to be heated, saving about 60% of the energy.

The device is equipped with smart sensors that allow you to hear in which area the towel is applied, this allows you to dry the cloth and keep the rest of the towel warmer at a low temperature. In this function, the temperature control is still active.

It is advisable to set a high temperature, avoiding interruptions.

To achieve maximum efficiency of this system, it is recommended to place the towel under electronic command. As per the diagram.

In all other positions, the energy saving is less than 60%.

This function is not effective in the case of towels positioned on the uprights.

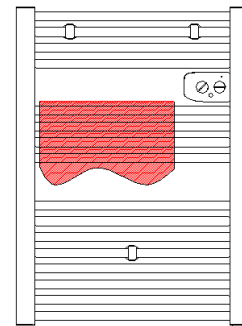

KEYPAD LOCK FUNCTION



The keypad lock is activated by pressing the [+] and [-] keys for about 5 seconds.

Once the lock is activated, the command beeps.

Once the lock is activated, the command stores the active function, and even if it is subsequently

changed, it maintains the chosen condition. To deactivate the lock, simply press the [+] and [-] for about 5 seconds.

ANTIFREEZE FUNCTION



This function is activated with the MODE button until the desired icon is activated

The unit turns on automatically when the ambient temperature falls below 7-8°C.

WINDOW CONTACT FUNCTION



This function is activated by default. To turn it off, it is necessary to press the mode and [+] keys simultaneously for longer than two seconds. The icon of the window disappears. Its function is to save energy

Automatic change from the active function to "Antifreeze" when a window being opened is perceived, (swift and sudden drop of temperature in less than 10 minutes), highlighted by a flashing of the window and antifreeze symbol simultaneously. The return to the previously selected function when the window is closed. (Stabilization of the temperature in a time less than 10 minutes).

In the event the active function is the Boost 2h, the command will automatically lead to the previous function.

AMBIENT FUNCTION

This function allows you to adapt the towel warmer to your bath. There are three levels: A/B/C.

We recommend trying the three different comfort degrees and seeing which best fits your needs.

For example: Windowless bathroom (recommended function B), Bathroom with large windows (recommended function C)